

多功能厅 / THE FOYER

摄影棚的主入口设有一个多功能厅,可用于展览和各类活动会场。

多功能厅不仅可以单独使用,也可以和西摄影棚一起使用。适用于较大型的展览以及活动。

设备齐全的厨房为多功能厅和摄影棚提供餐饮服务。

THE GRAND ENTRANCE TO THE STUDIOS IS A VERSATILE EXHIBITION / EVENT SPACE THAT CAN BE USED EXCLUSIVELY AS A GALLERY OR COMBINED WITH THE ADJACENT WEST STUDIO TO ACCOMMODATE LARGER EVENTS. A FULLY EQUIPPED KITCHEN WITHIN THE FOYER SPACE SERVES THE STUDIOS FOR IN HOUSE OR EVENT CATERING OPTIONS.

特色 FEATURES:

125平方米, 5.2米高

空调

大型物品搬入口

画廊照明设备

无线网络

设备齐全的厨房和意式咖啡机

休息室, 衣帽间和前台

可快速通往西棚

125 sqm with 5.2m High ceilings

Reverse Cycle A/C

3.7m High x 3m Wide entrance doors

Exhibition Lighting

Wi-Fi

Full service kitchen with espresso machine

Lounge, cloakroom, and receptionist (optional)

Immediate access to West Studio

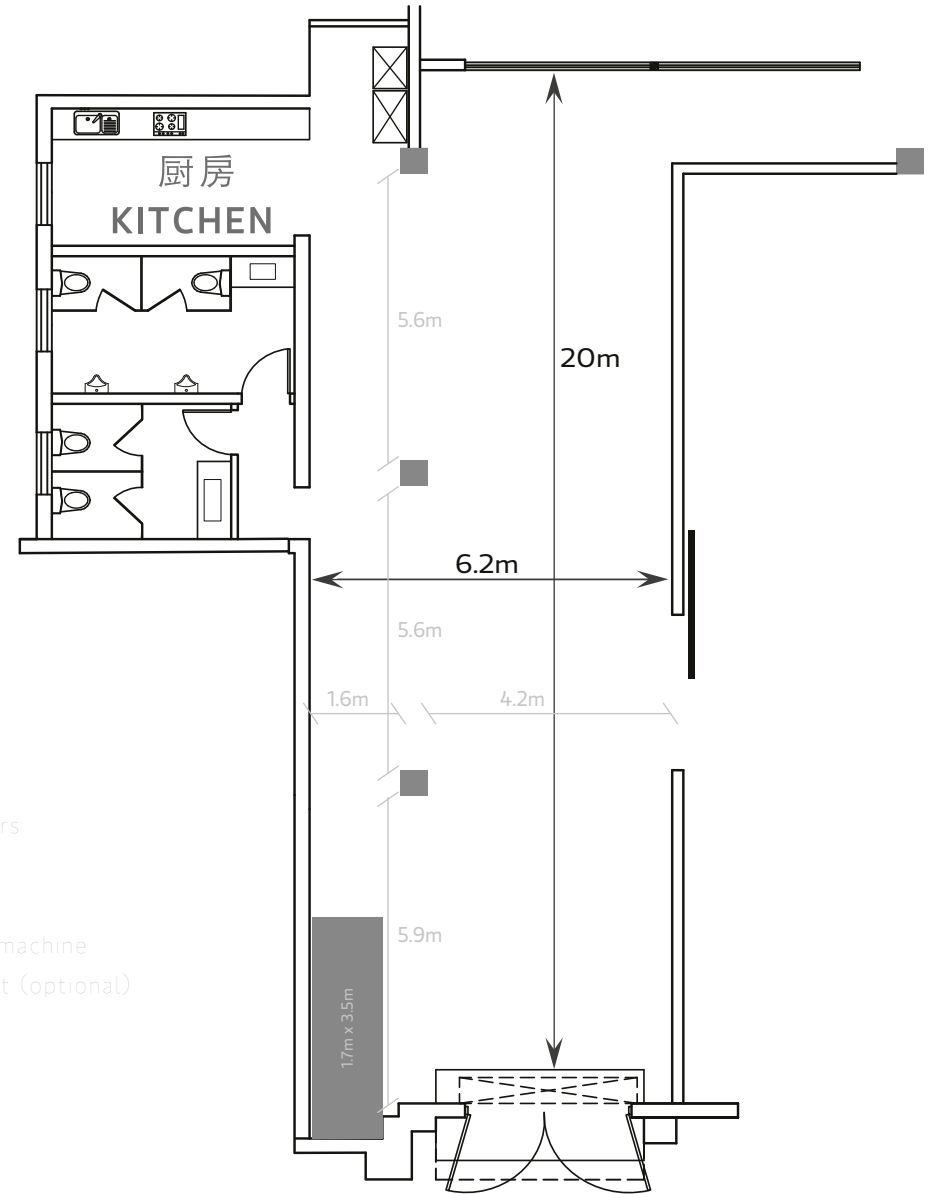

CENTRALSTUDIOS